

## CS Series

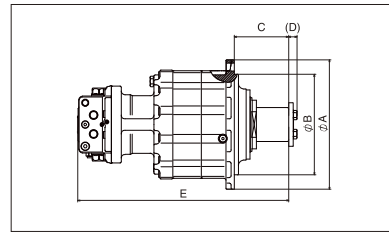

### [Main Application]

- Slewing units with reducer for cranes, elevated work vehicles, mining equipment, etc.

### [Features]

- Supports feed and swivel
- Compact shaft rotation motor
- Built-in parking brake
- 2-speed motor (high/low speed)



### ■ Specification

		CS04	CS05A	CS09B
Rated Output Torque	N-m	2940	3920	8630
Max. Output Speed	min-1	60	56	60
Max. Pressure	MPa	24.5	20.6	31.4
Max. Flow Rate (ref.)	L/min	51	73	97

### ■ Outline Dimensions

		CS04	CS05A	CS09B
A	mm	280	306	342
B	mm	175	230	265
C	mm	104	120	144
(D)	mm	19	20	22
E	mm	405	408	533.5

## MFD/MFC Series



### [Main Application]

- Swing motors for various construction machines such as hydraulic excavators

### [Features]

- Lightweight, compact, low-noise motor with excellent micro-operability
- Floating valve plate structure with high efficiency and excellent self-priming performance

### ■ Specification

		MFD30	MFC40	MFD80	MFD140	MFC160	MFC200	MFC250
Max. Motor Displacement	cm <sup>3</sup> /rev	27	45	80	131	151	187	250
Max. Pressure	MPa	20.5	24.5	27.9	29.4	29.4	29.4	29.4
Max. Flow Rate (ref.)	L/min	40	80	130	220	220	290	360